

FSI TYPE DIN 69051 form B

ROLLED BALLSCREW

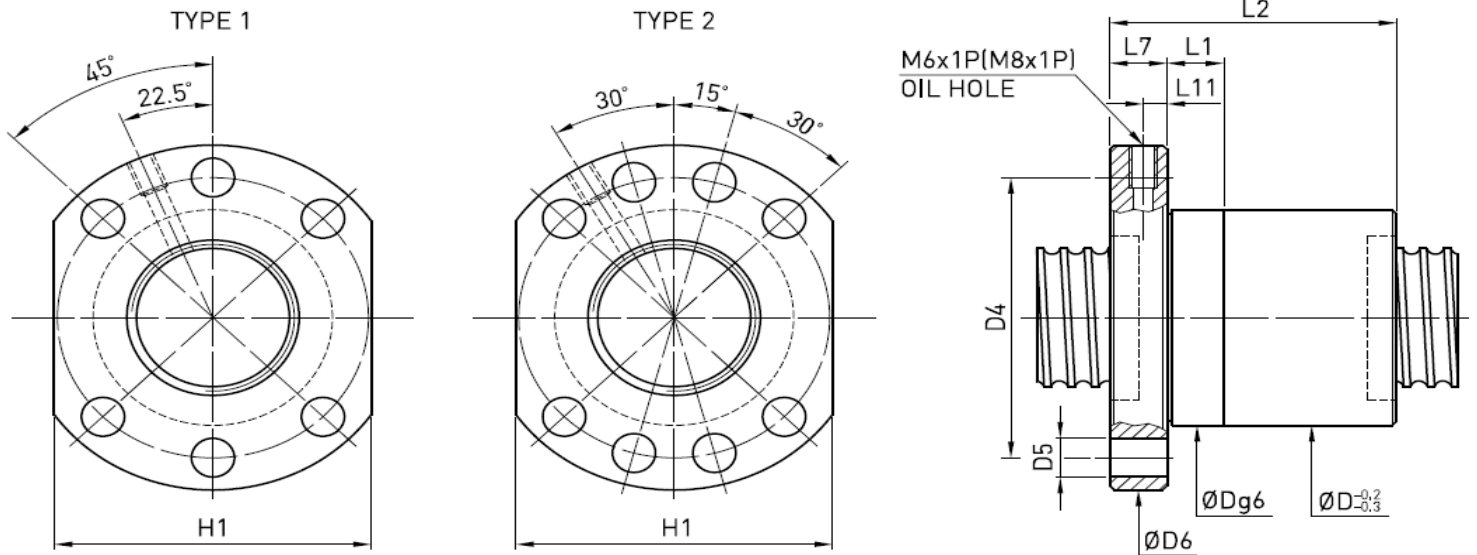

| Model | Size | | Ball Dia. | Circuits | Dynamic Load 1×10^6 revs C (kgf) | Static Load Co (kgf) | D | D4 | Flange Hole No | D5 | D6 | H1 | L1 | L2 | L7 | L11 | M - Oil Hole |
|---------|--------|------|-----------|----------|--|----------------------------|----|----|----------------------|-----|-----|----|----|----|----|-----|-----------------|
| | Nom.D. | Lead | | | | | | | | | | | | | | | |
| 16-5T3 | 16 | 5 | 3.175 | 3 | 1000 | 2000 | 28 | 38 | 6 | 5.5 | 48 | 40 | 10 | 40 | 10 | 5 | M6x1P |
| 20-5T4 | 20 | | 3.175 | 4 | 1490 | 3550 | 36 | 47 | 6 | 6.6 | 58 | 44 | 10 | 52 | 10 | 5 | M6x1P |
| 25-5T4 | 25 | | 3.175 | 4 | 1690 | 4660 | 40 | 51 | 6 | 6.6 | 62 | 48 | 12 | 52 | 10 | 5 | M6x1P |
| 25-10T3 | | 10 | 4.763 | 3 | 2160 | 4860 | 40 | 51 | 6 | 6.6 | 62 | 48 | 16 | 65 | 10 | 5 | M6x1P |
| 32-5T4 | 32 | 5 | 3.175 | 4 | 1920 | 6210 | 50 | 65 | 6 | 9 | 80 | 62 | 10 | 53 | 12 | 6 | M6x1P |
| 32-5T6 | | | 3.175 | 6 | 2730 | 9320 | 50 | 65 | 6 | 9 | 80 | 62 | 10 | 66 | 12 | 6 | M6x1P |
| 32-10T4 | | 10 | 6.350 | 4 | 4680 | 11550 | 50 | 65 | 6 | 9 | 80 | 62 | 16 | 85 | 12 | 6 | M6x1P |
| 40-5T4 | 40 | 5 | 3.175 | 4 | 2110 | 7770 | 63 | 78 | 8 | 9 | 93 | 70 | 10 | 53 | 14 | 7 | M8x1P |
| 40-10T4 | | 10 | 6.350 | 4 | 5170 | 14240 | 63 | 78 | 8 | 9 | 93 | 70 | 16 | 87 | 14 | 7 | M8x1P |
| 50-5T4 | 50 | 5 | 3.175 | 4 | 2330 | 9990 | 75 | 93 | 8 | 11 | 110 | 85 | 10 | 57 | 16 | 8 | M8x1P |
| 50-10T4 | | 10 | 6.350 | 4 | 5880 | 18660 | 75 | 93 | 8 | 11 | 110 | 85 | 16 | 89 | 16 | 8 | M8x1P |